

Buran

1:96

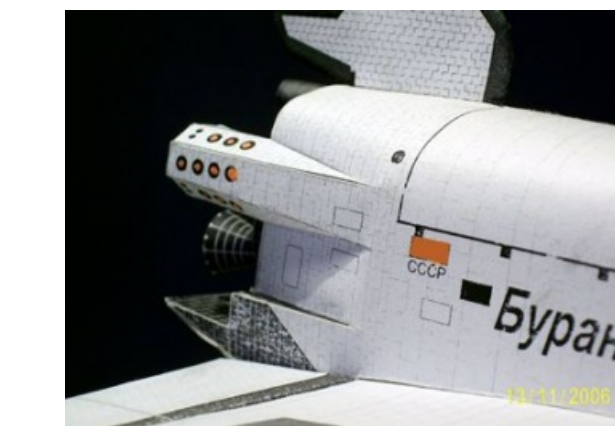
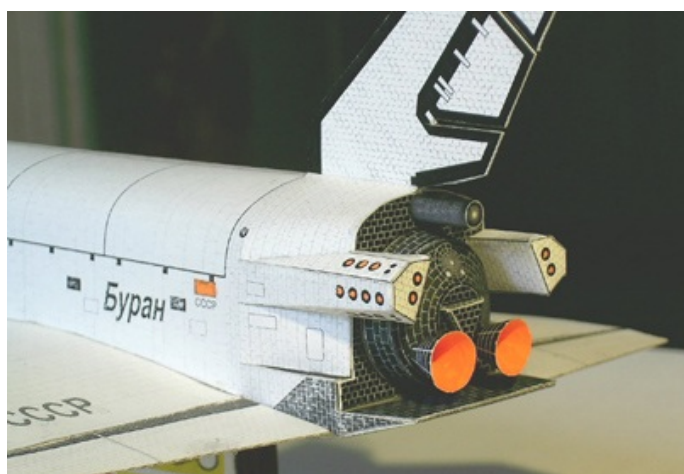
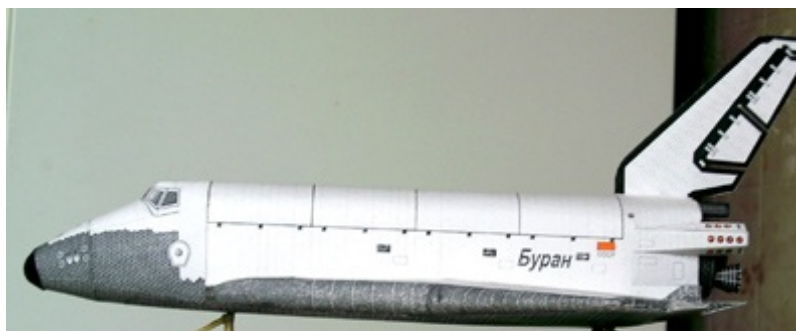
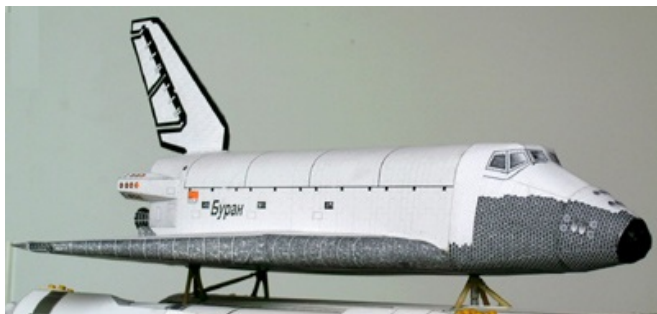

Paper used:
0,15 mm - 130 gr
0,26 mm - 200 gr
Glue: PVA

rev.3
see pages
2, 4, 6, 18,
20



● ○ parachute container

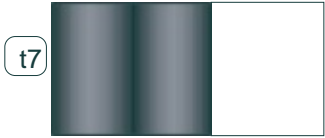

tail

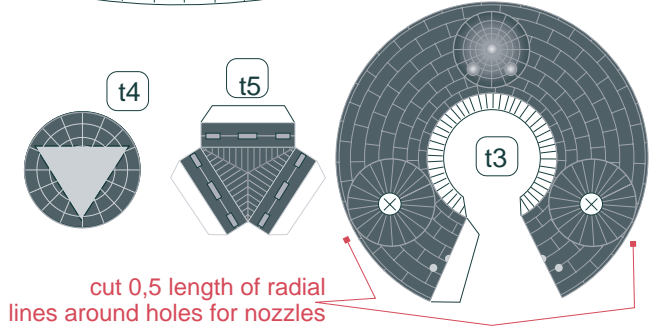
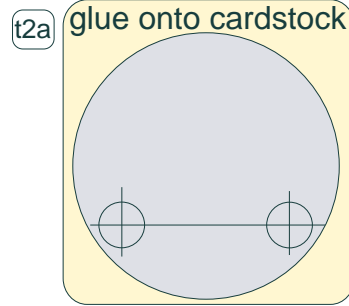
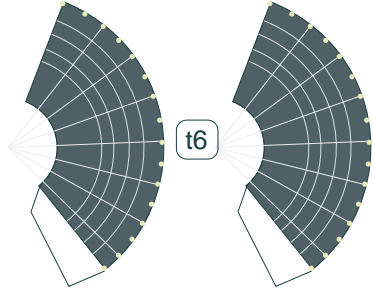
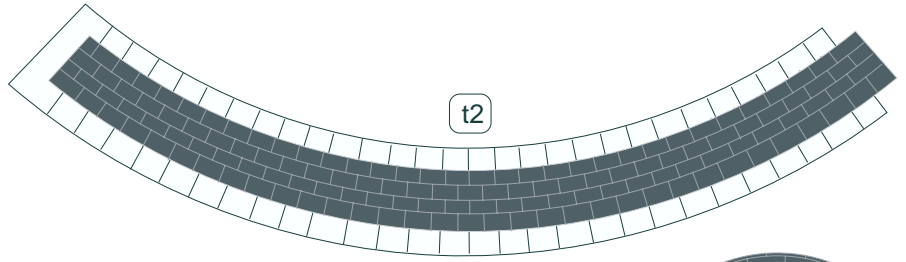

pod of fuel tank & mine engines

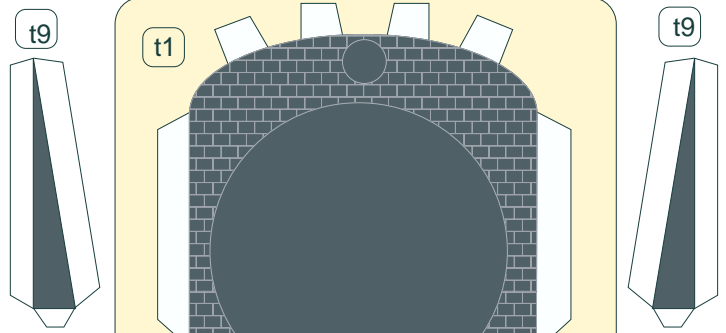

glue onto cardstock

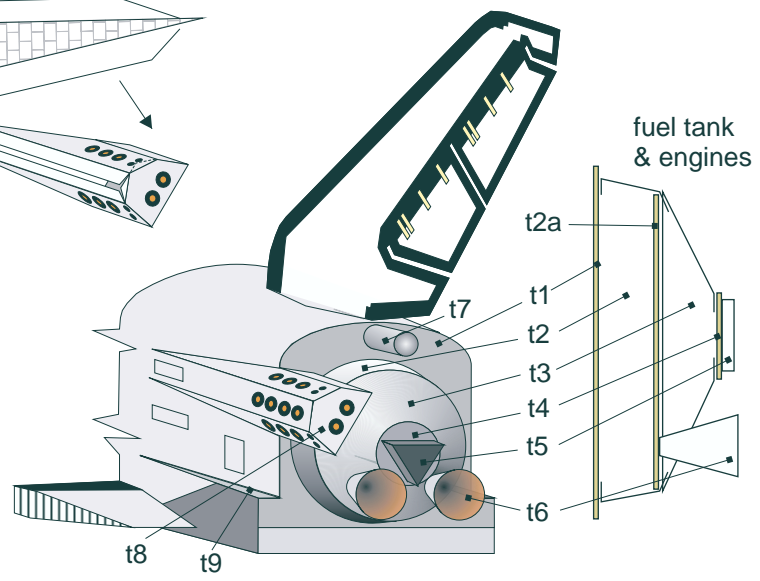
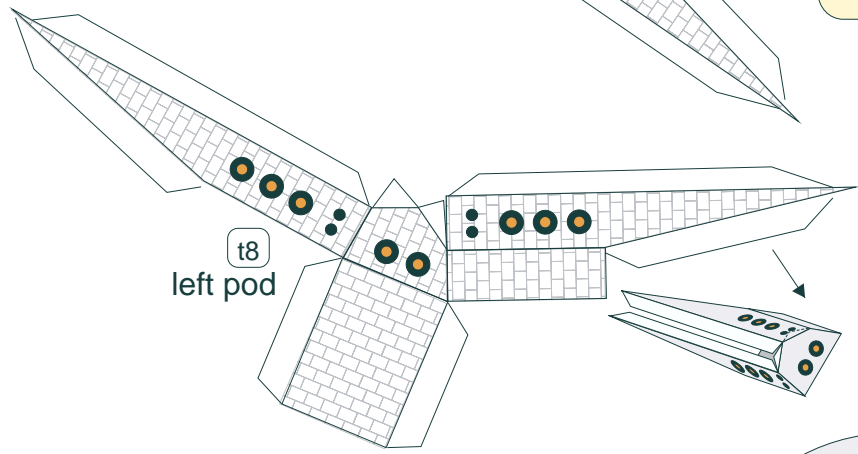
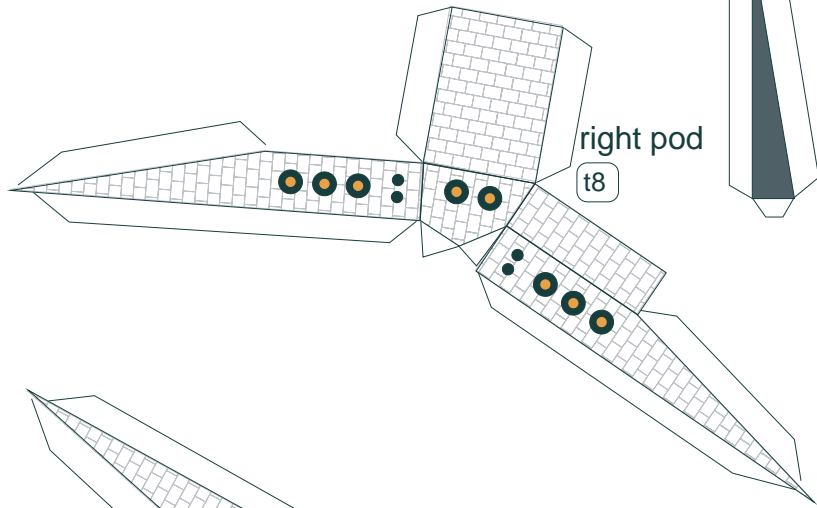

fuel tank & engines

10 cm

hull

h1

h2

Буран

Буран

СССР

СССР

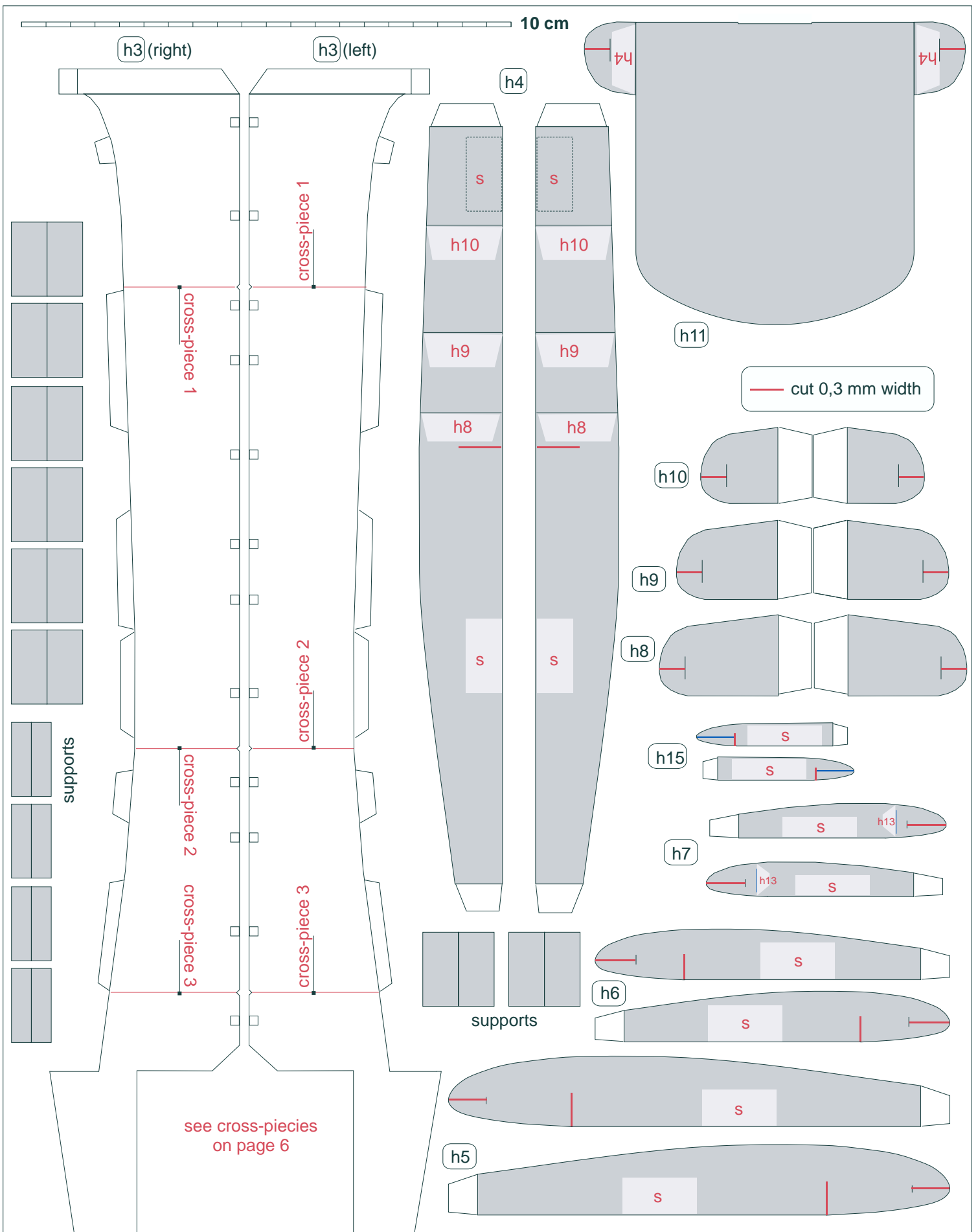

10 cm



front

first spar right

h12

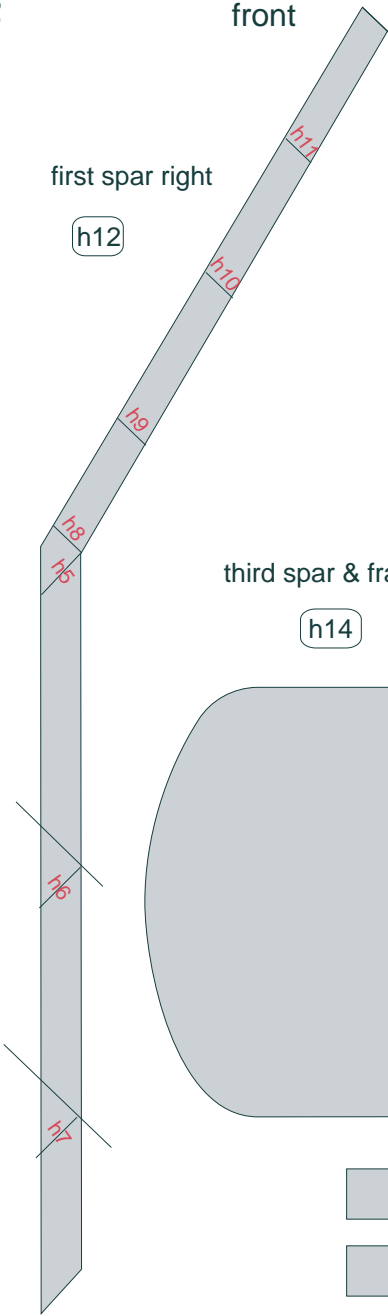

third spar & frame

h14

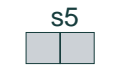
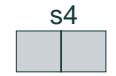
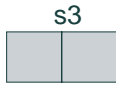
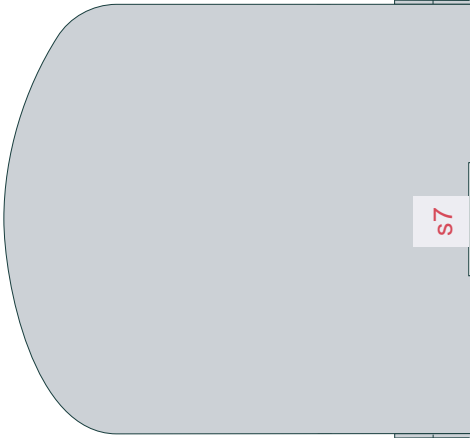

— cut 0,3 mm width



front

first spar left

h12

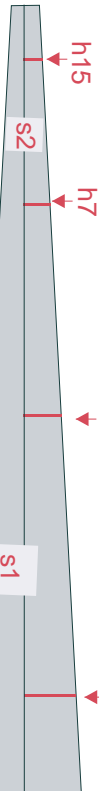
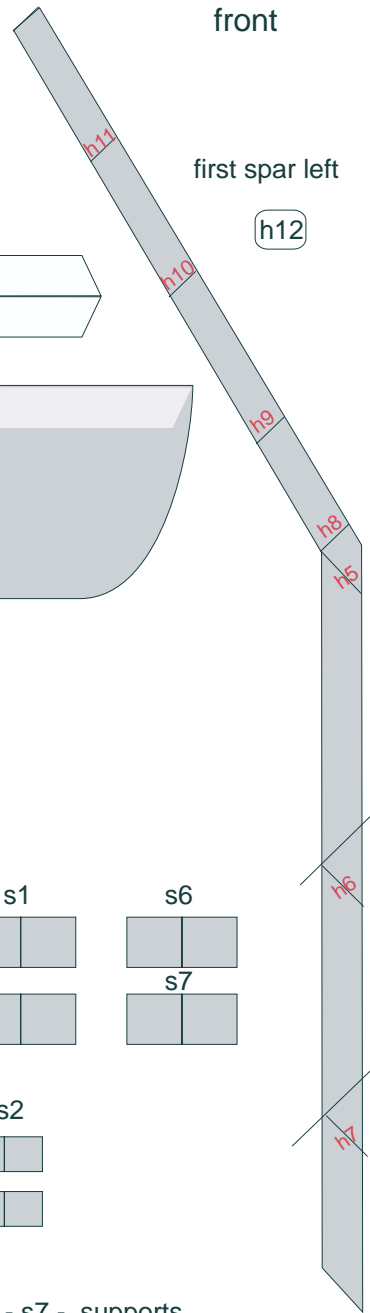

second spar & frame

h13

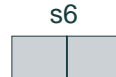
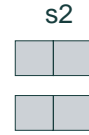

s1 - s7 - supports



10 cm

frame of bottom (left part)

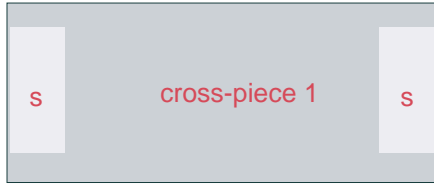

cross-piece 1

bend gently along this lines

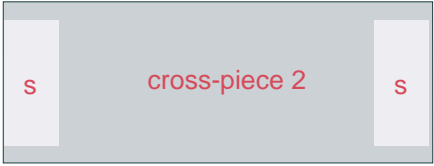
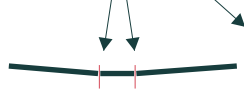

cross-piece 2

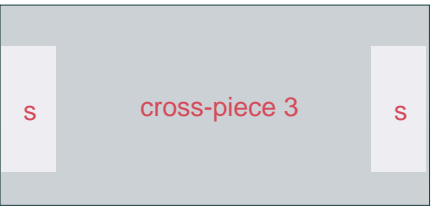

cross-piece 3

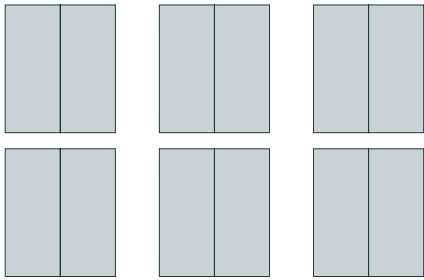

supports for cross-piece

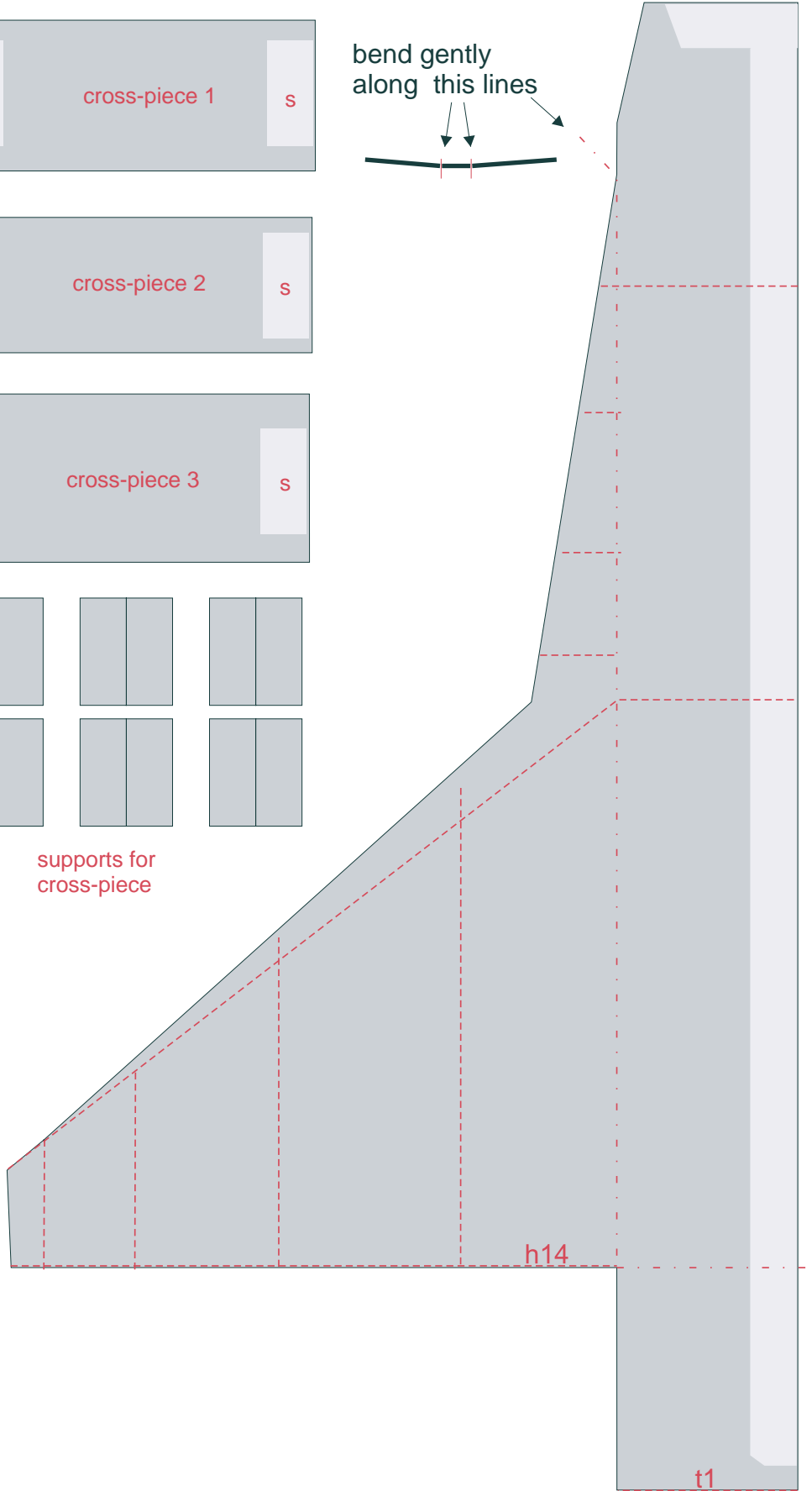

10 cm

frame of bottom (right part)

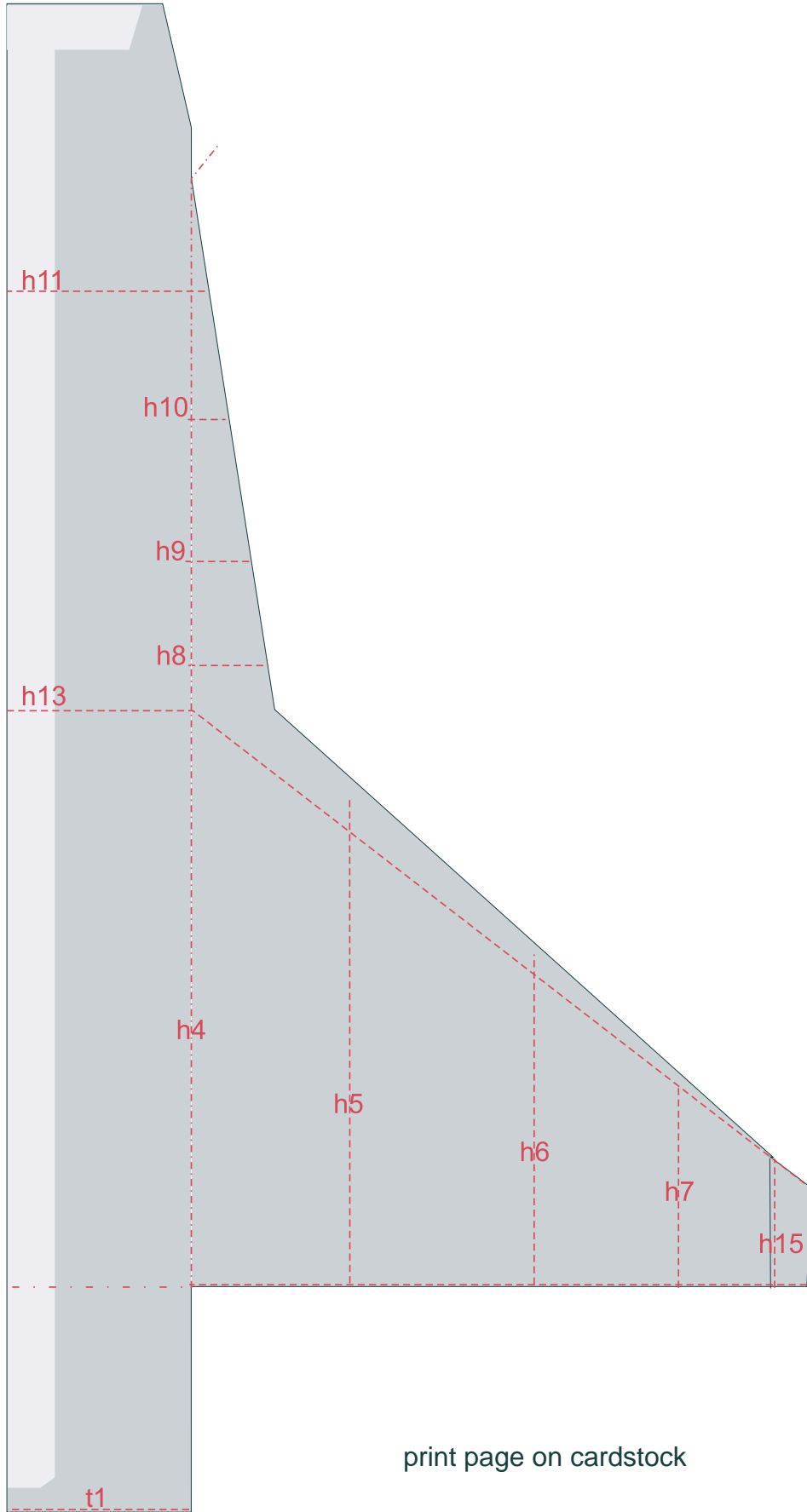

bend gently along this line (after glueing of left & right parts)

print page on cardstock

10 cm

cockpit

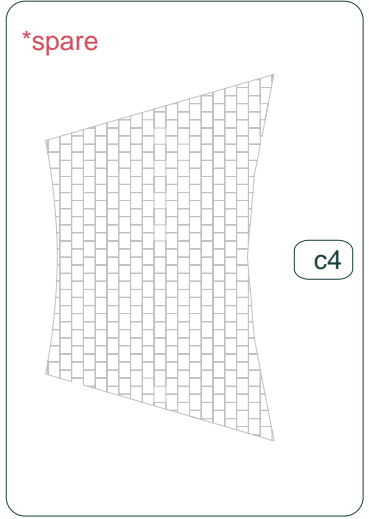
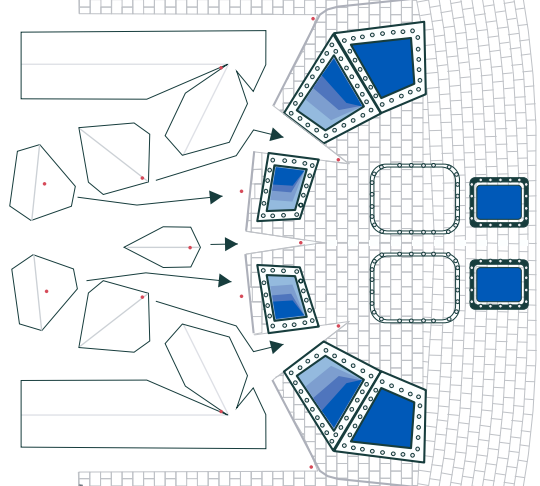
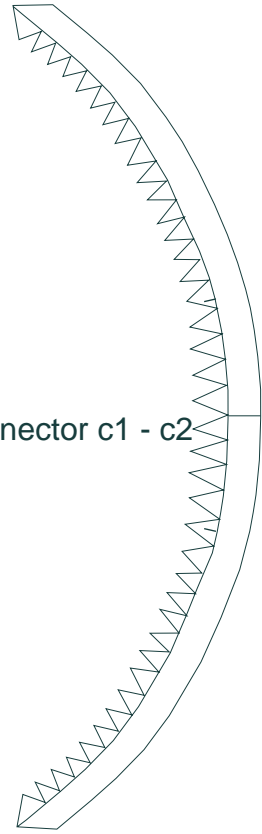
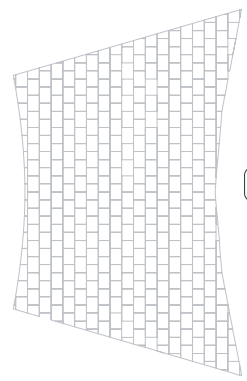
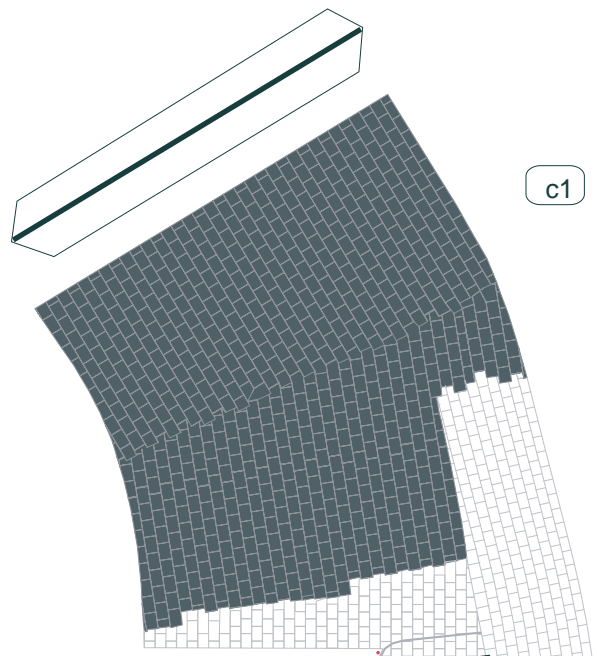
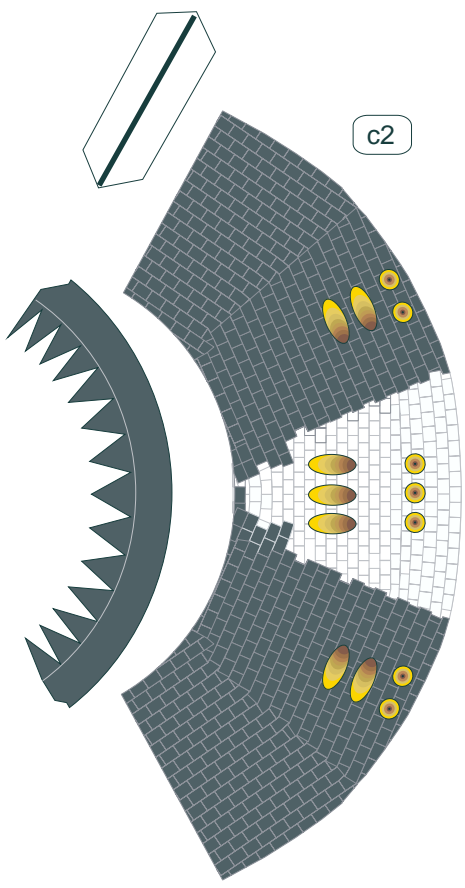

first glue c1,
then glue c4 on c1,
then glue connector c1 - c2

10 cm

wing left

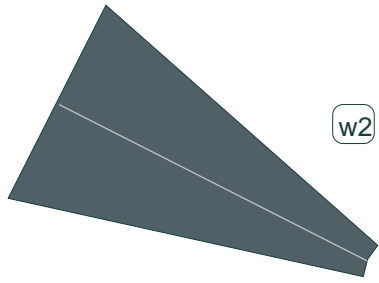

w2

cut

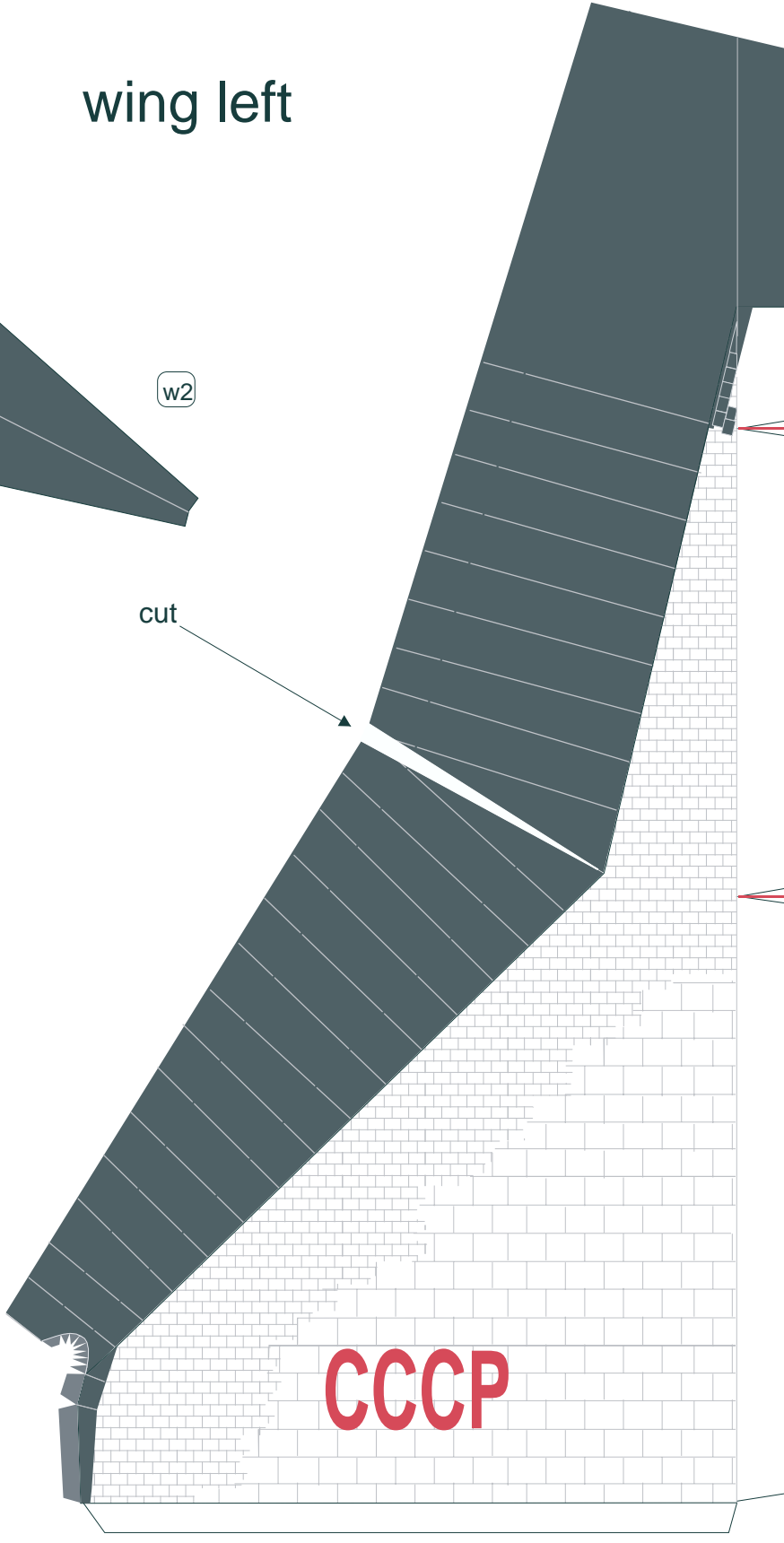

w1

w3



СССР

10 cm

wing right

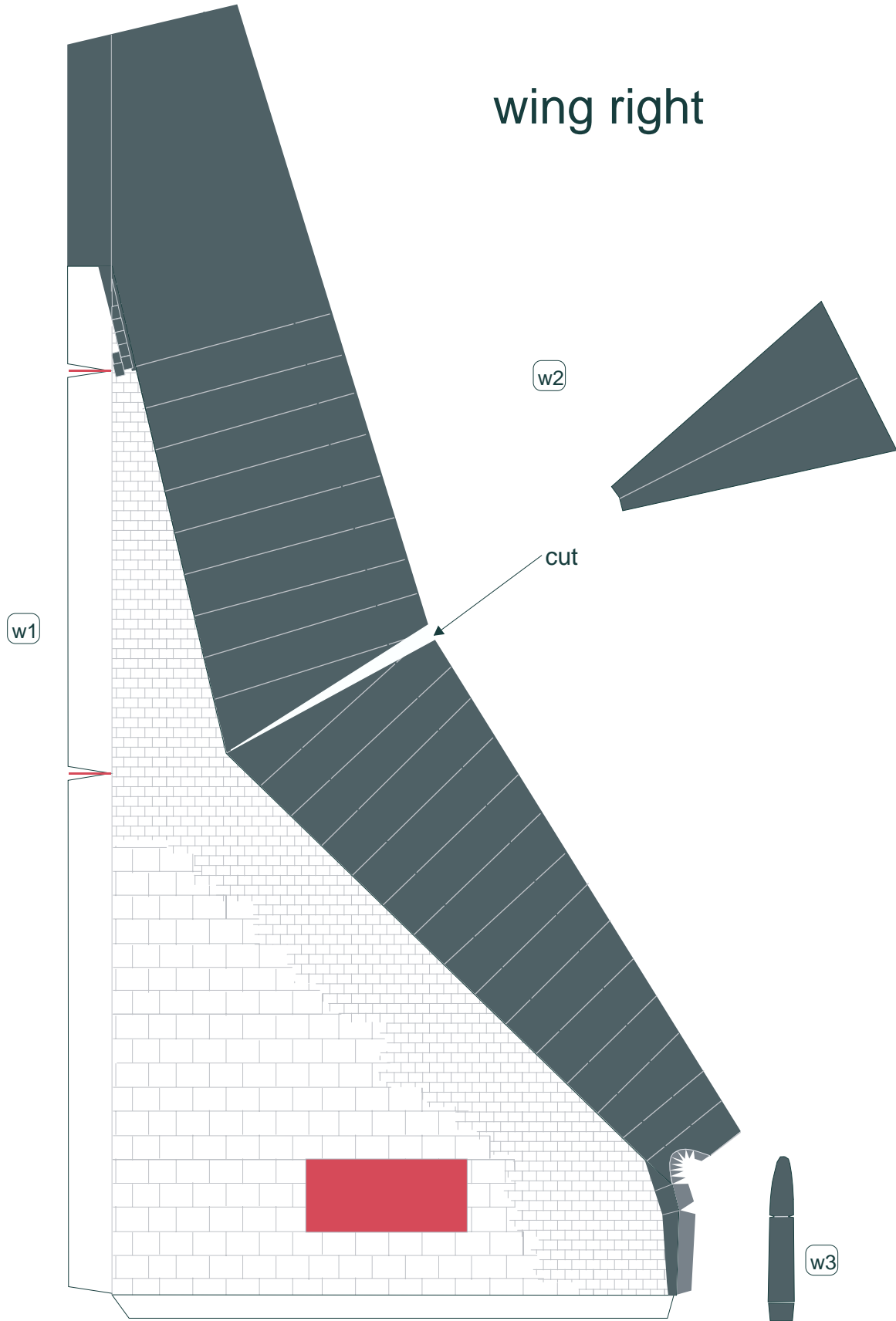

10 cm

elevones

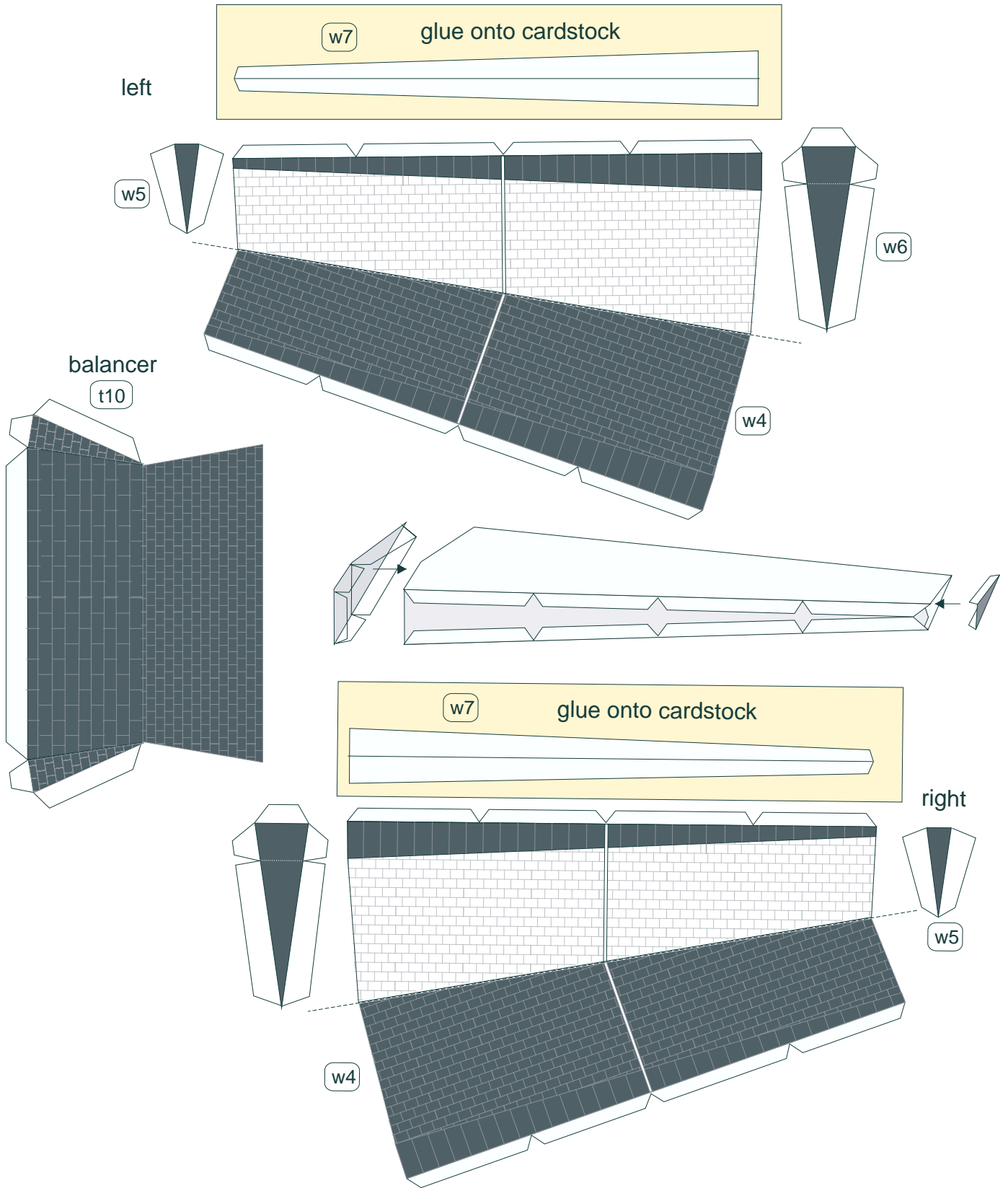

10 cm

bottom (right part)

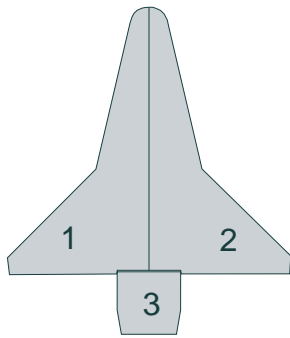

1

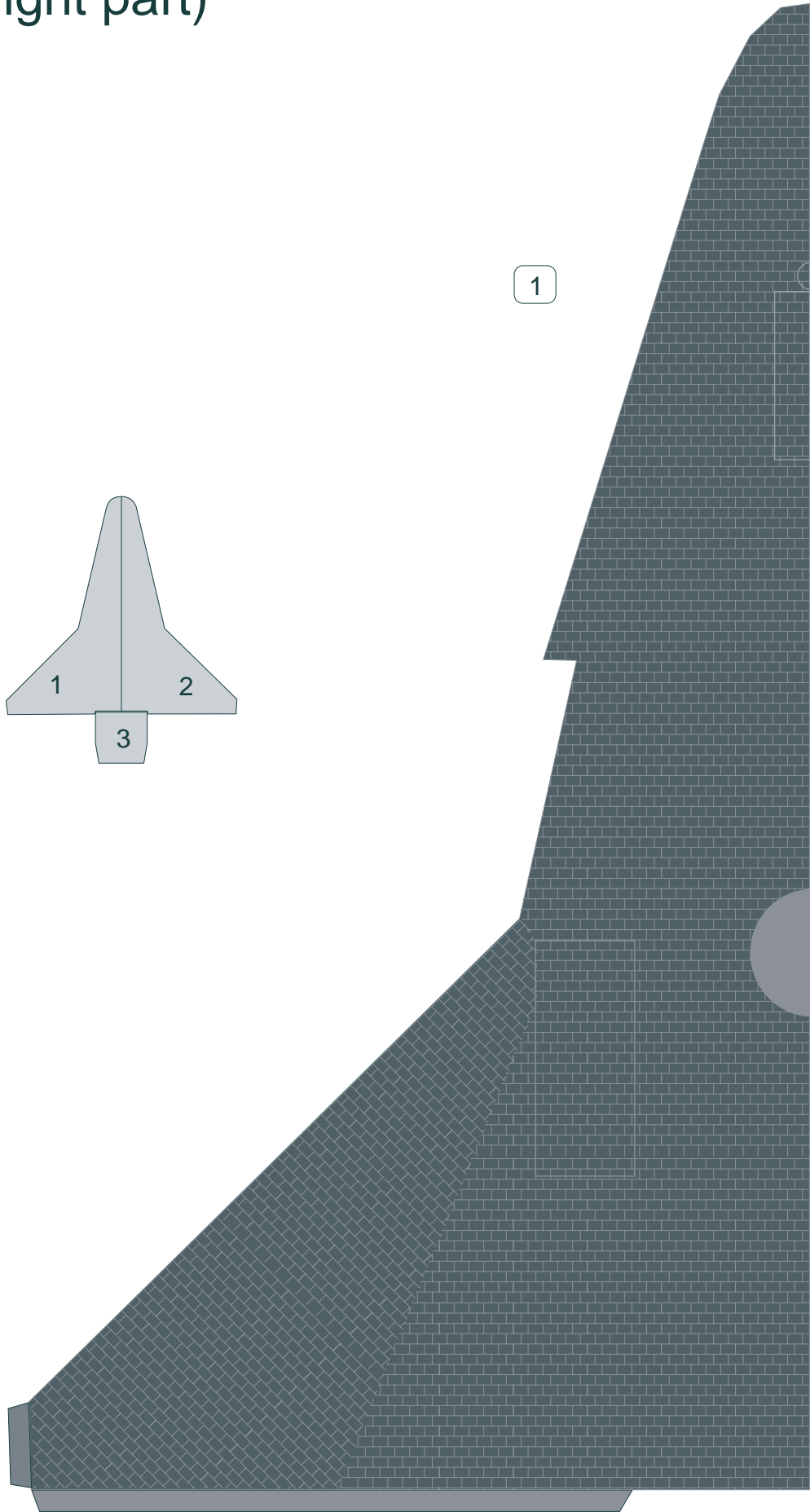

10 cm

bottom (left part)

Left & right parts - butt joint !
(and part 3 - also)

2

3

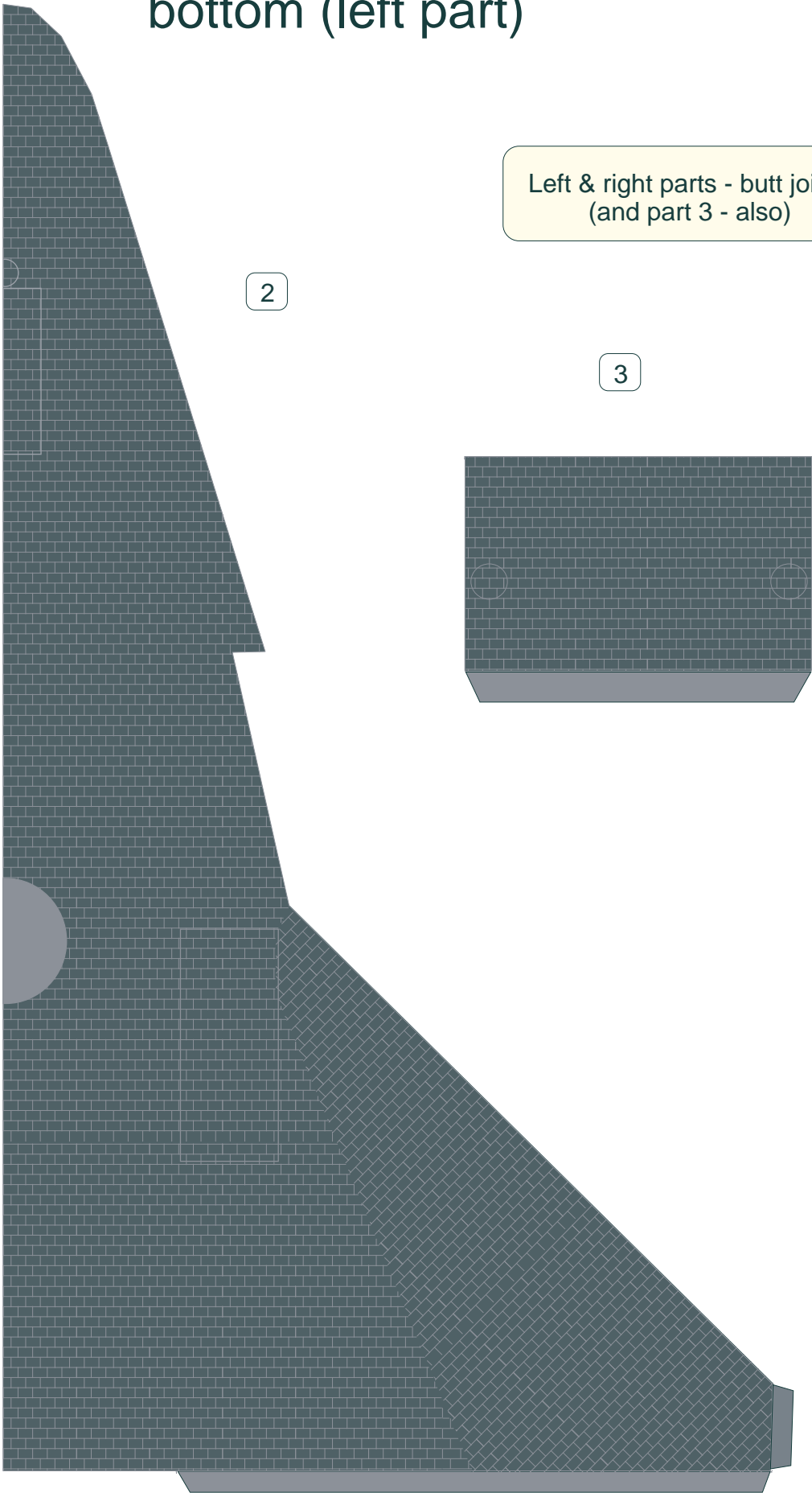

10 cm

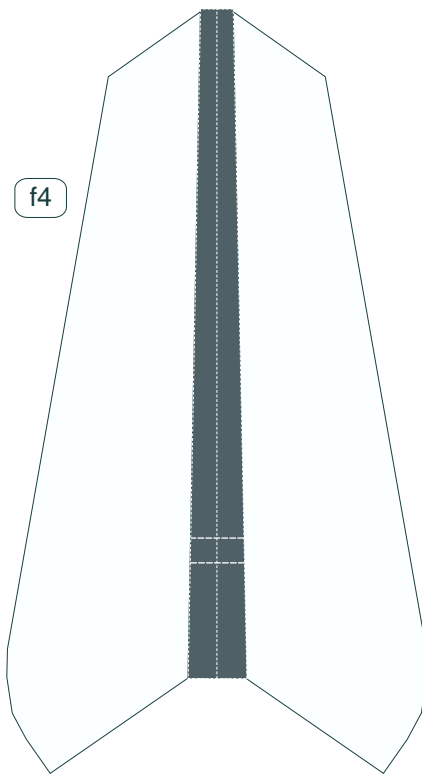

f4

using of f4
see p.13

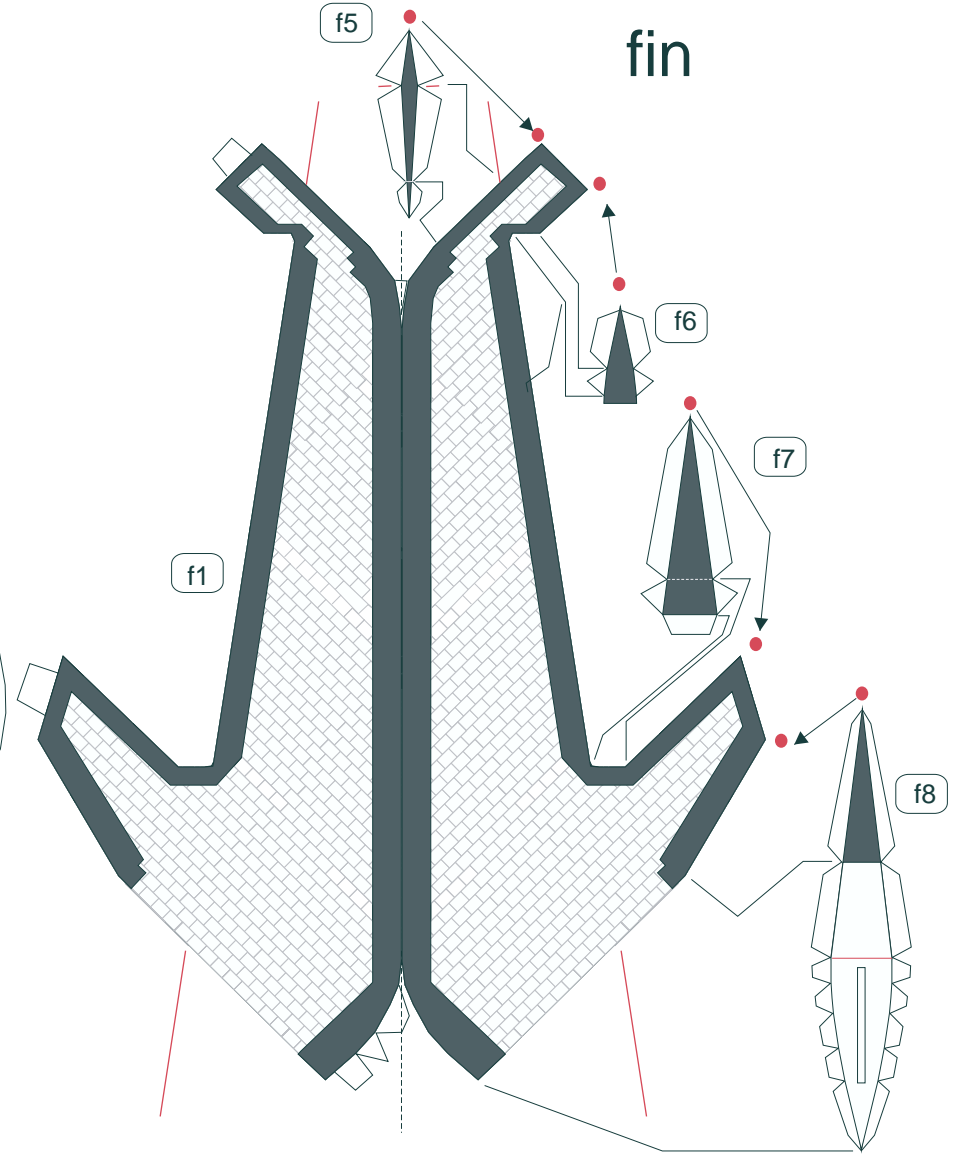

f1

f5

fin

f6

f7

f8

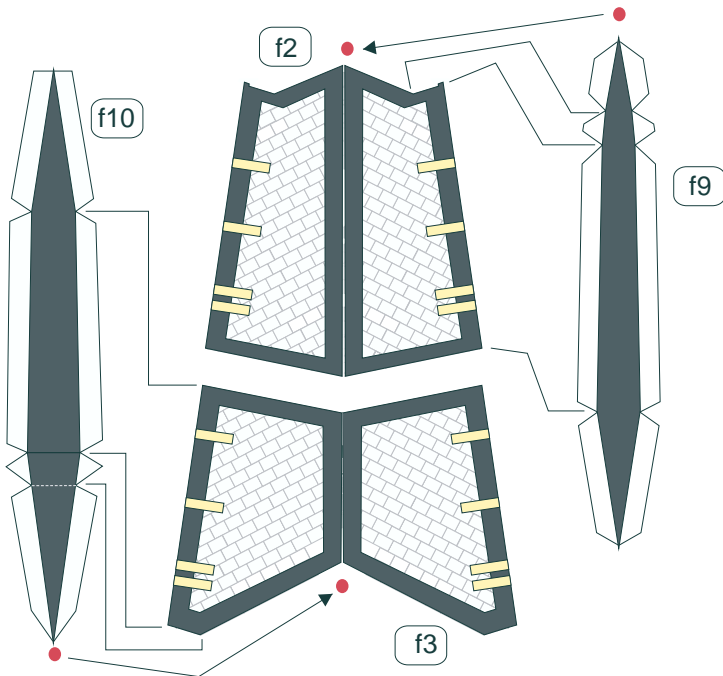

f2

f10

f9

f3

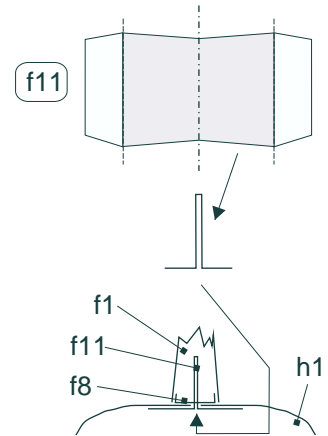

f11

f12

f1

f11

f8

h1

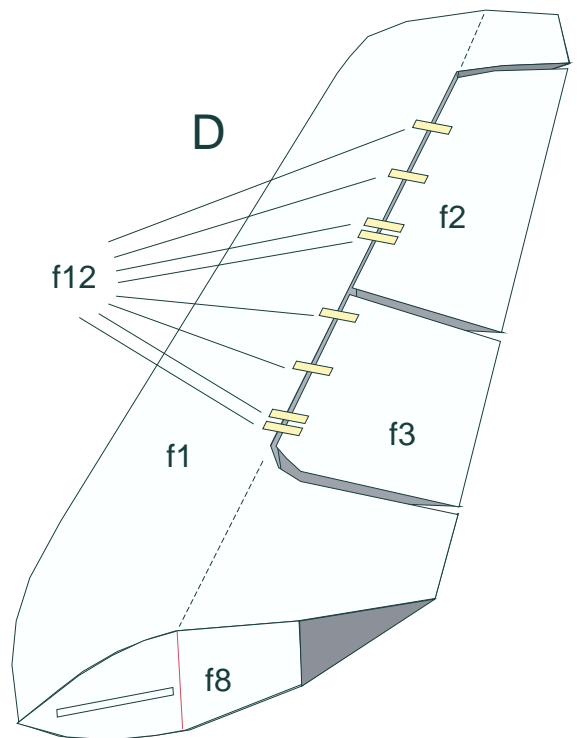
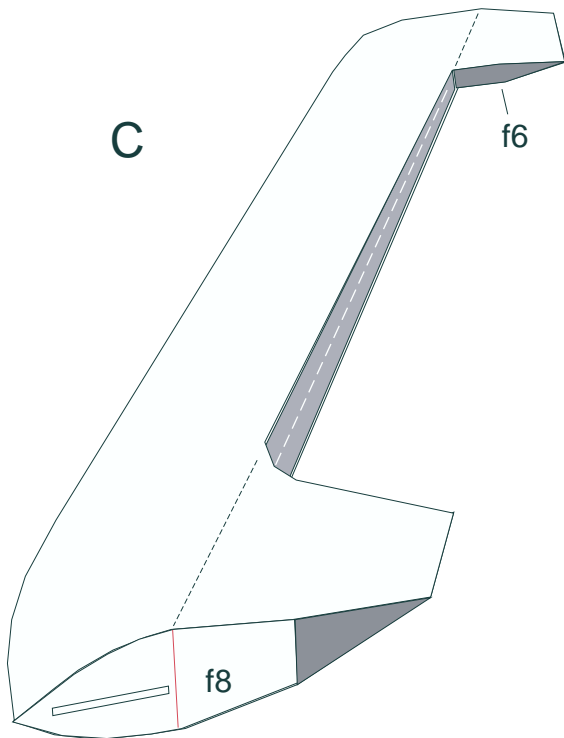
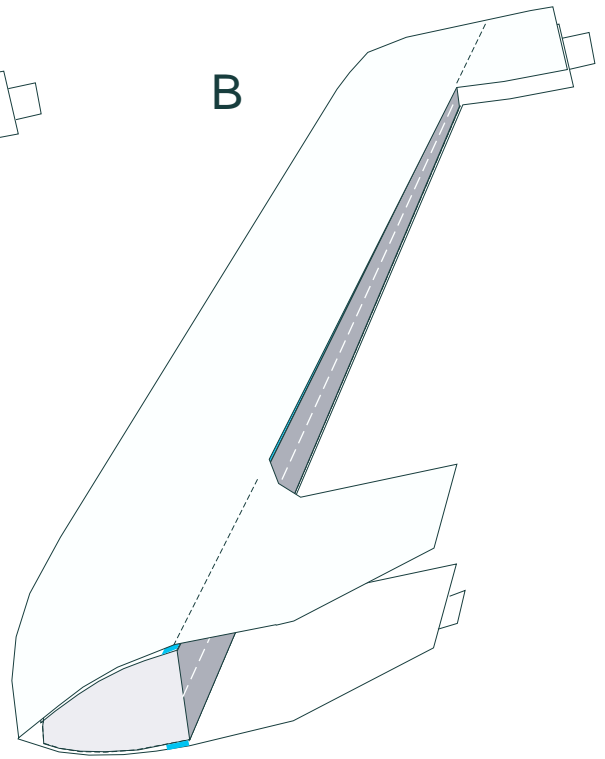
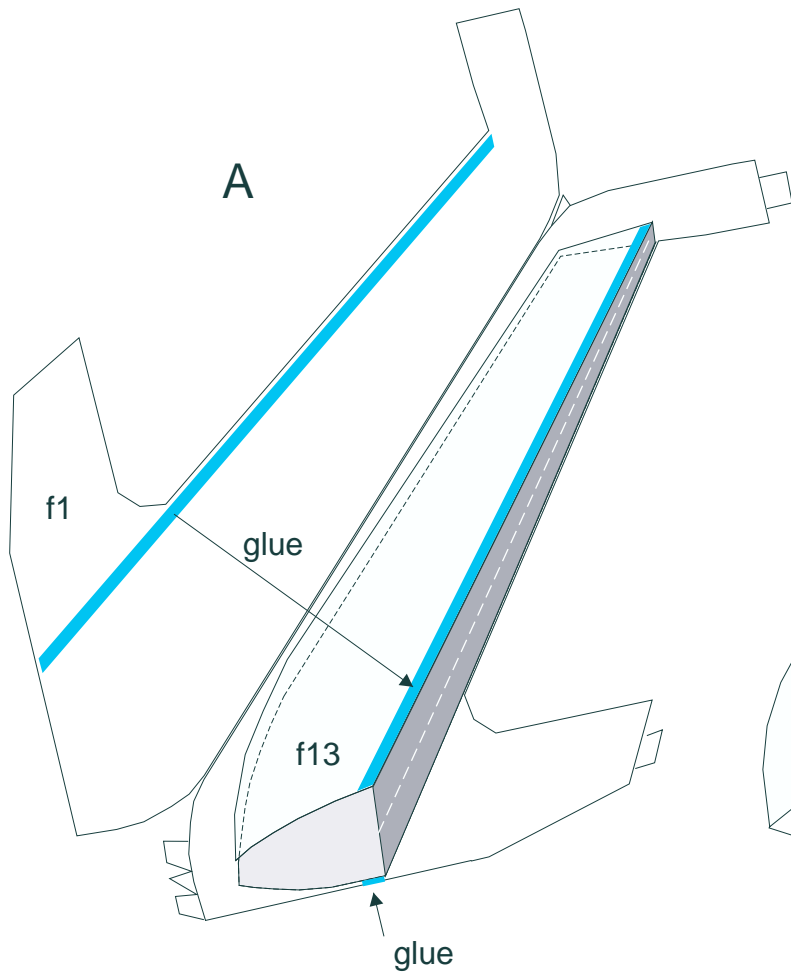

10 cm

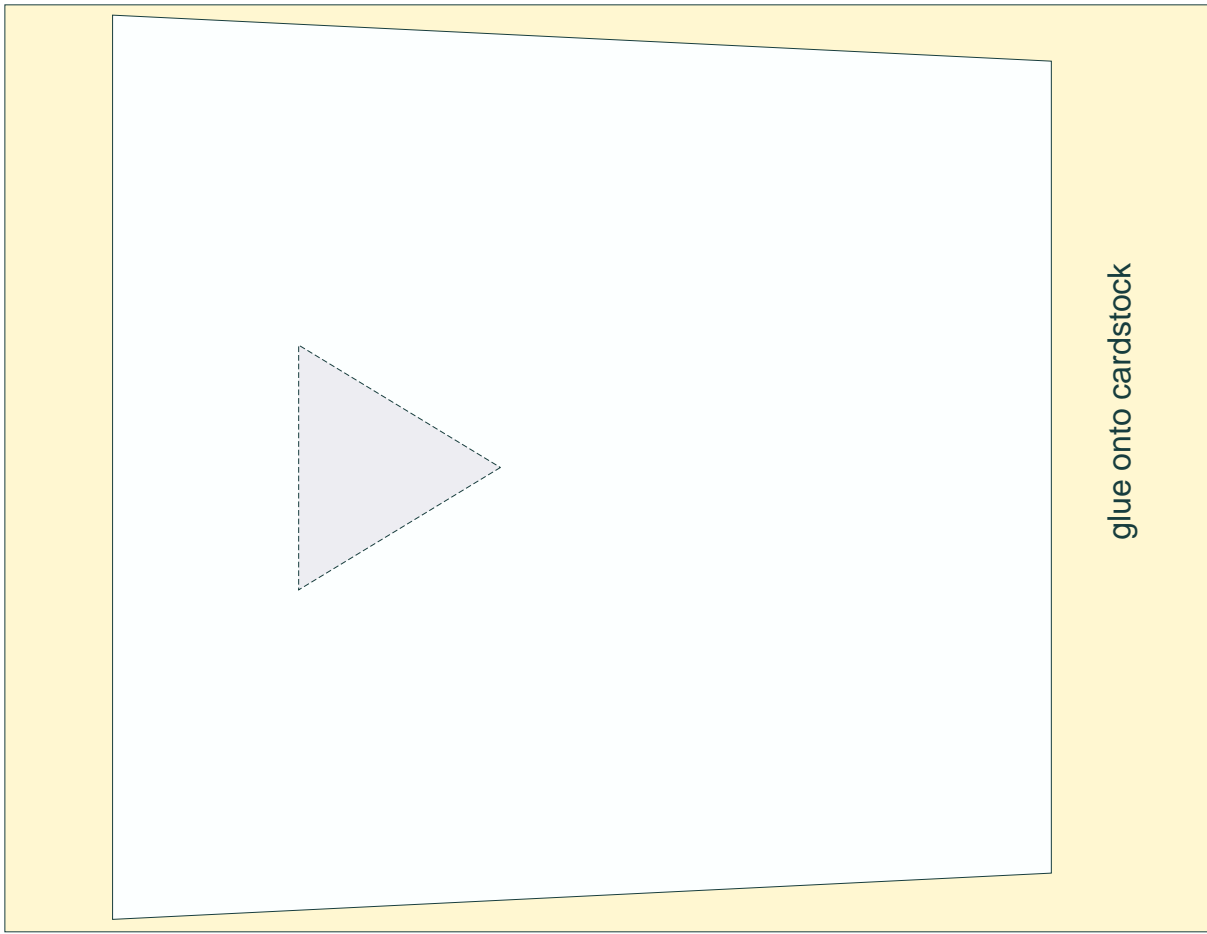

“arrow” from next page
glue onto detail A
(see grey triangle)

then assembly
detail B (“arrow” pass
through triangle hole)

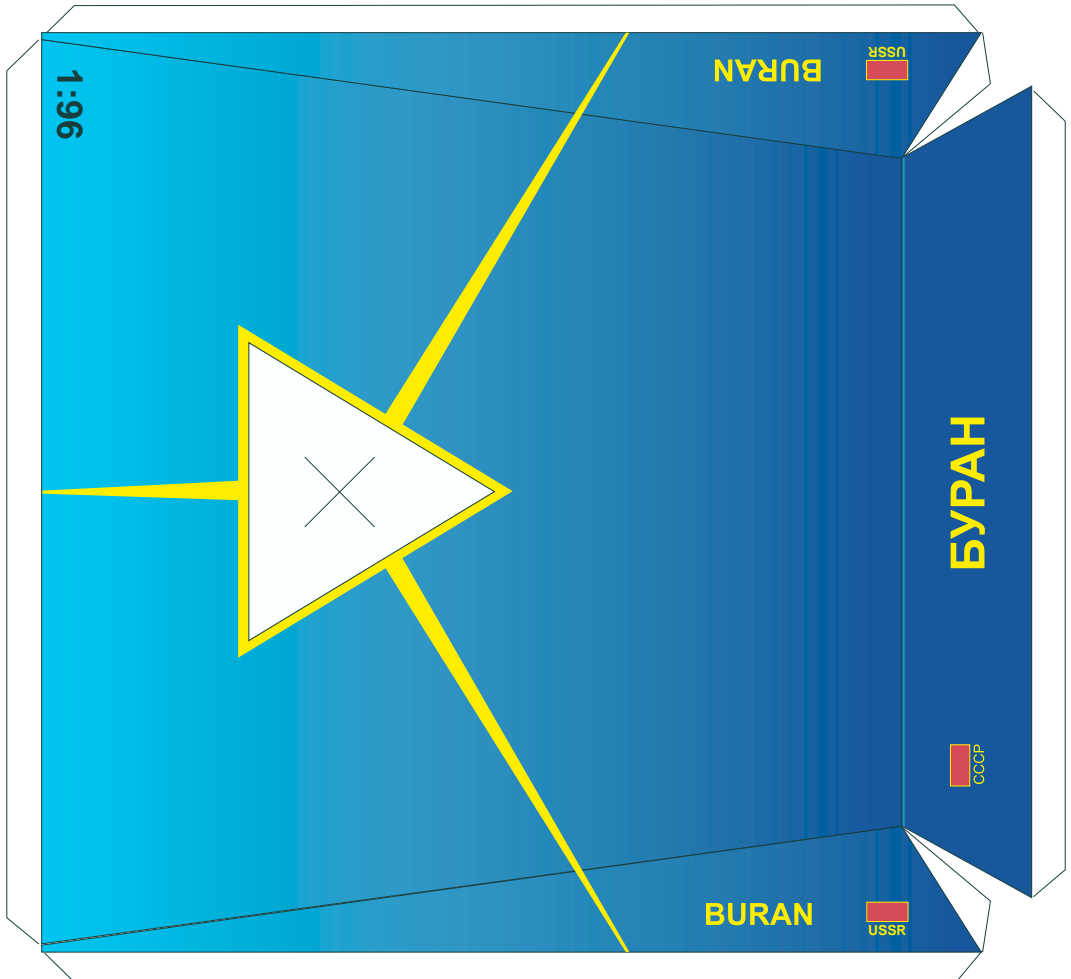

10 cm

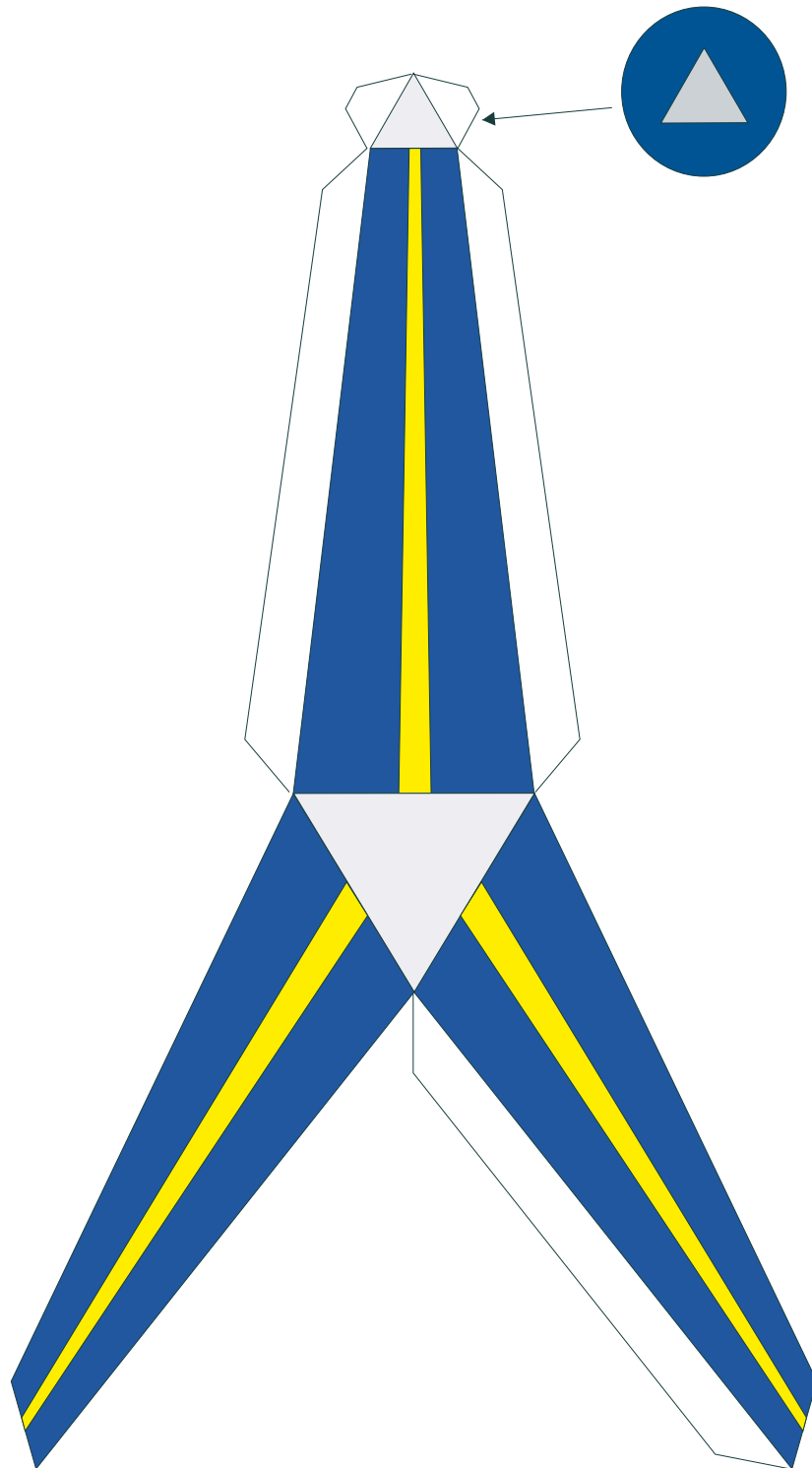

Print on cardstock

Steps of assembling

Step 1

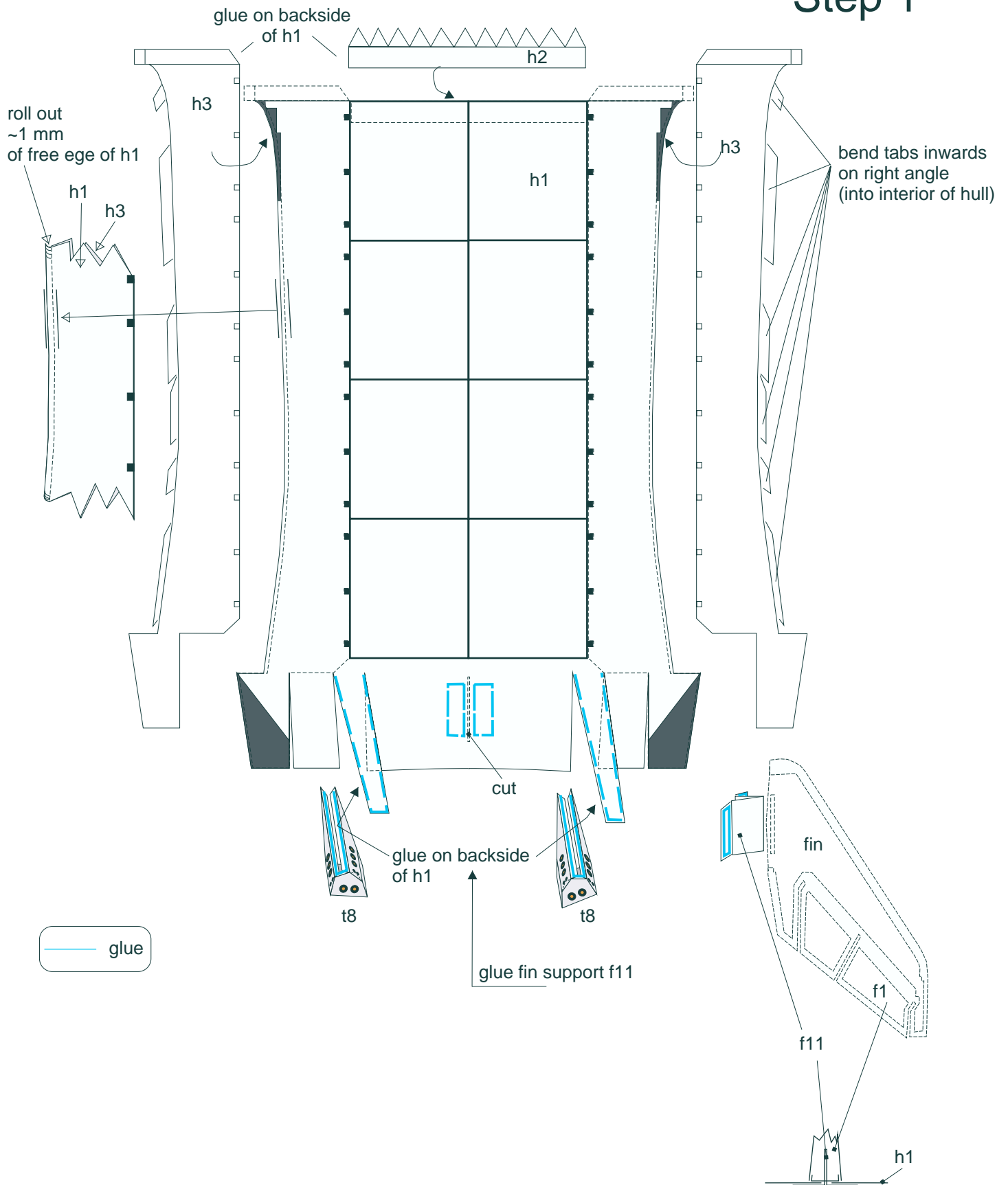

Steps of assembling

Step 2

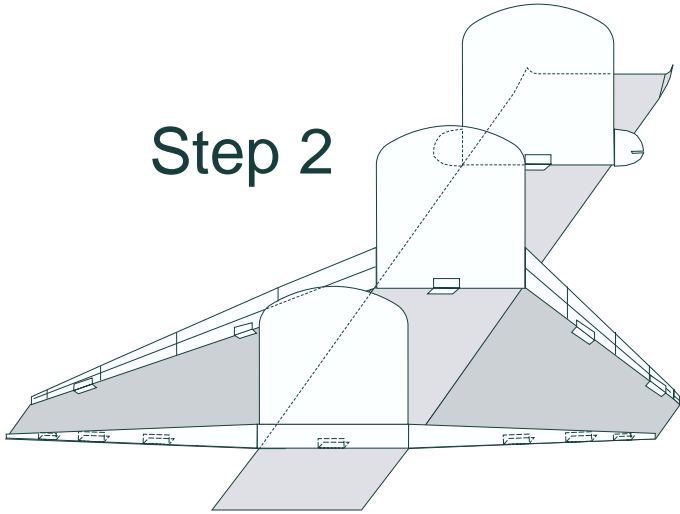

Step 3

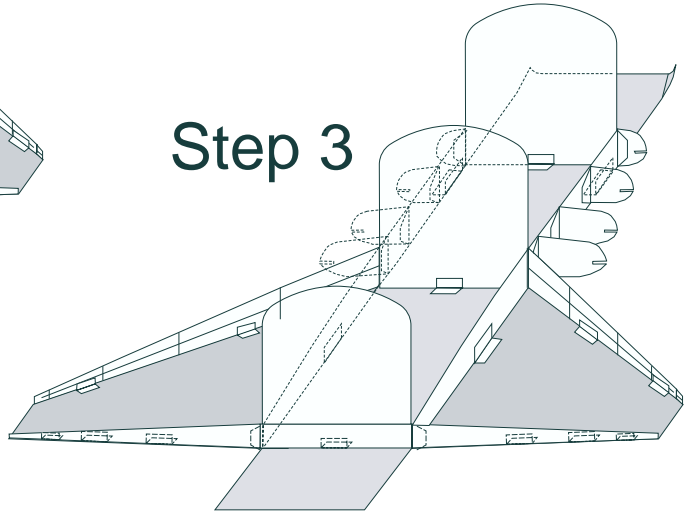

Step 4

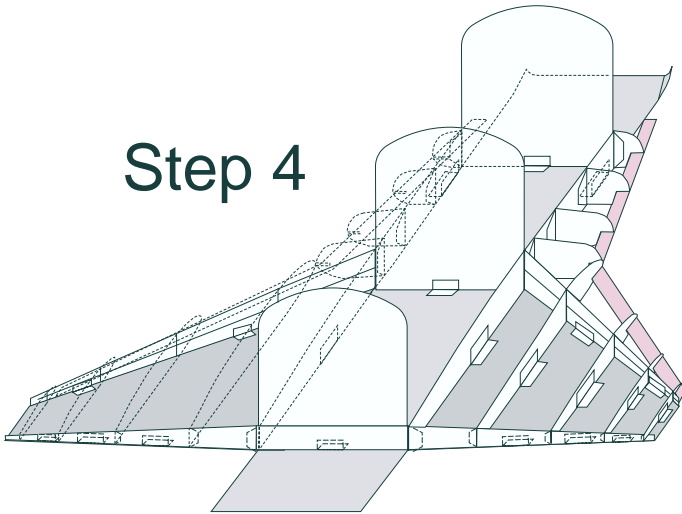

Step 5

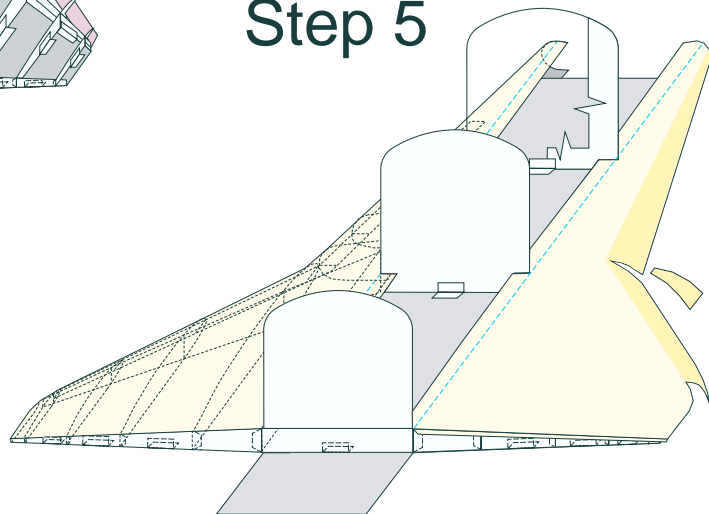

Steps of assembling

Step 6

1- bend h1 conformally to parts h13 & h14 on frame, glue **cross-pieces 1, 2, 3**

2- glue pod of mine engines

3- glue left & right pods, in final lines 1 and 2 are **parallel**

4- assembly cocpfit

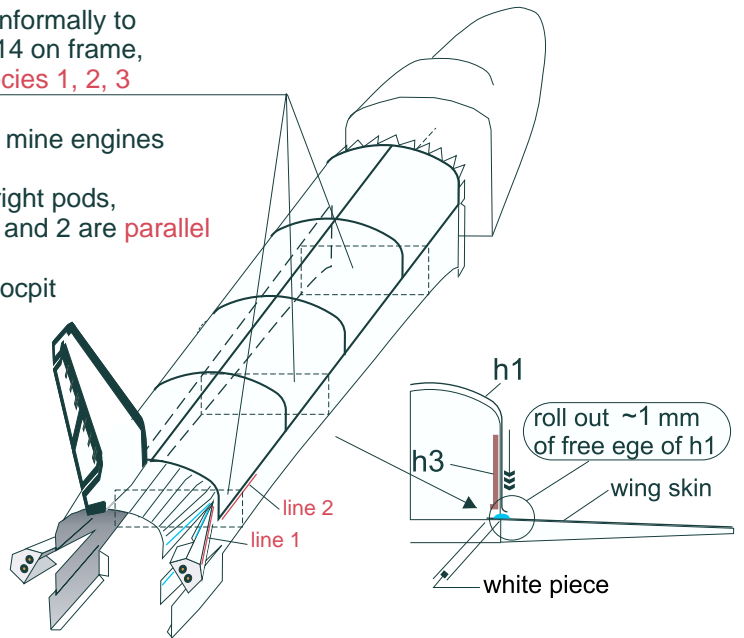
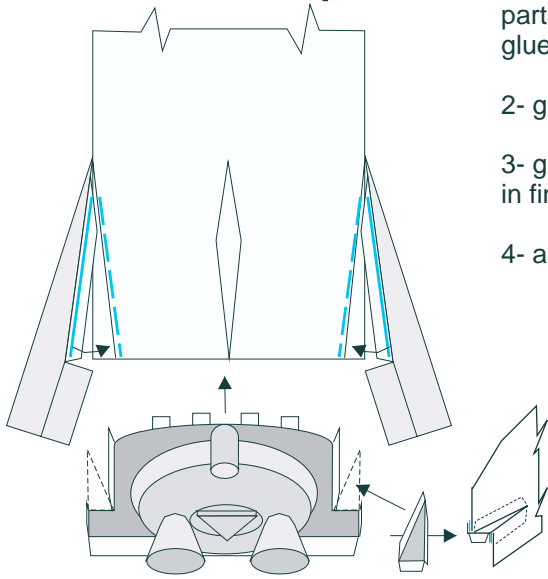

Step 7

Assembling of hull

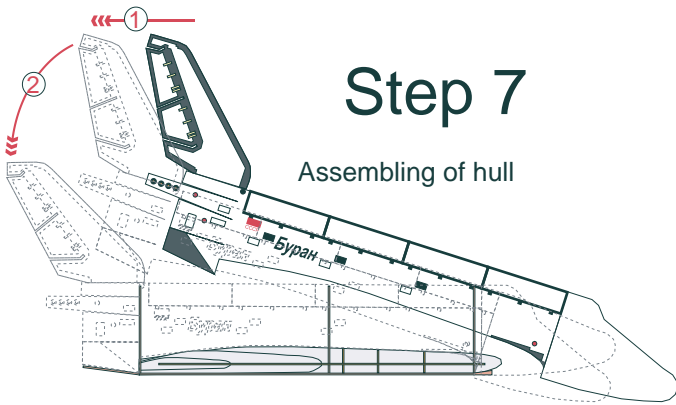

front parts of wing skins are inside cocpfit

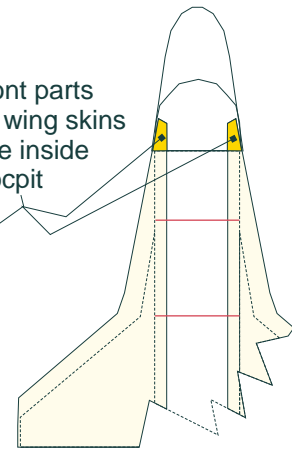

Step 9a

Step 9b

Step 9c

Step 9

Step 8

